

Carbon Steel Weld Fitting & Weld Flange Products for Piping Construction

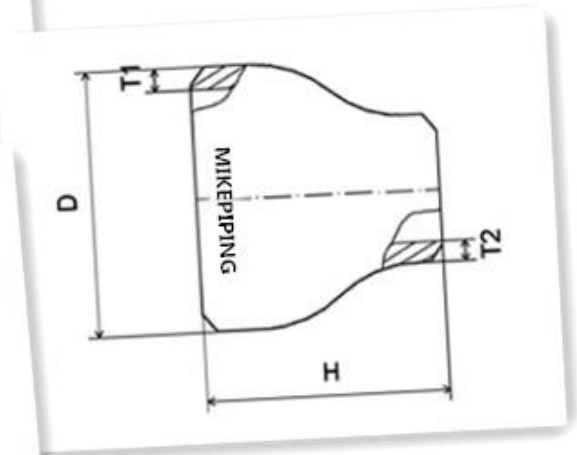
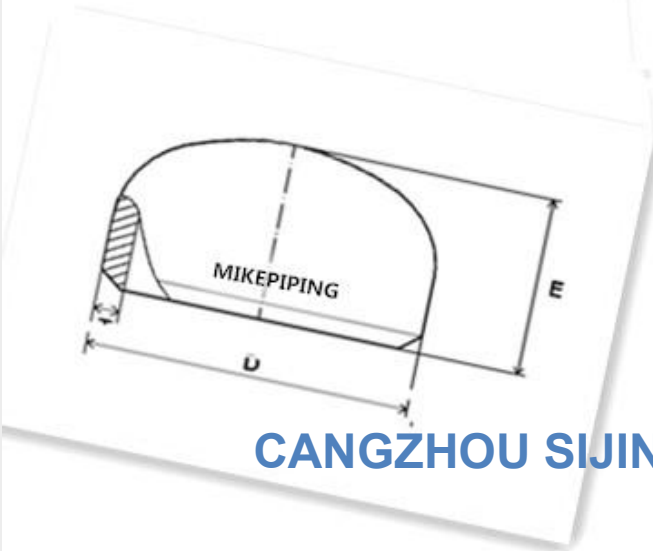
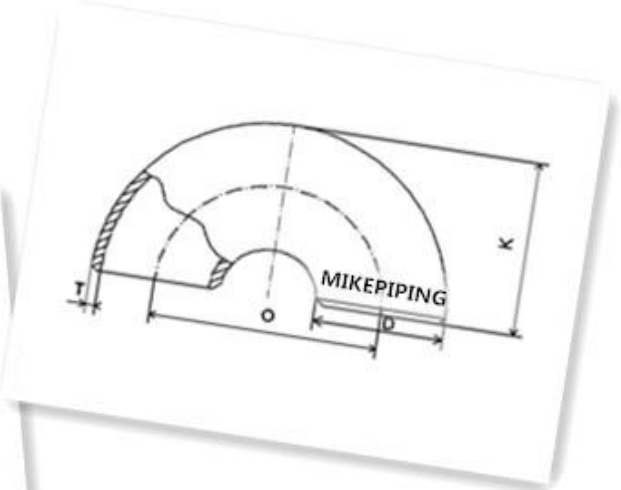
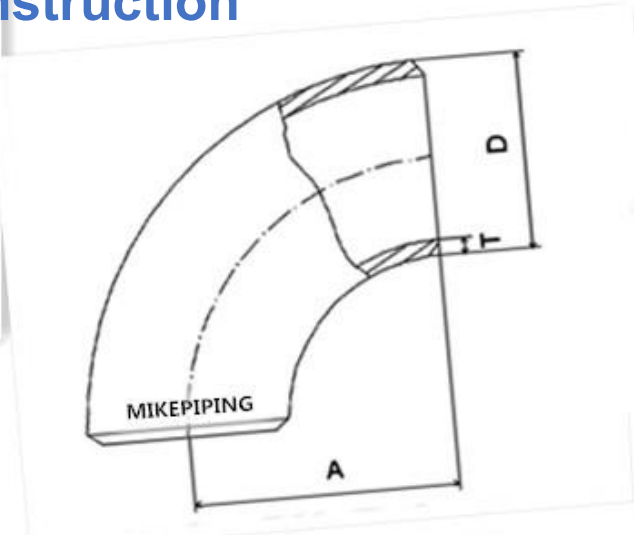

CANGZHOU SIJIN INTERNATIONAL TRADING CO.,LTD

MIKEPIPING
SOLUTION

SIJIN
思进国际

CANGZHOU SIJIN INTERNATIONAL TRADING CO.,LTD
沧州思进国际贸易有限公司



WORLD CLASS PROVIDER OF THE PIPING SOLUTIONS

More than 10 years trade experience in pipeline industry.
We are an excellent piping exporter,
professional steel pipe supplier.
world class provider of the piping solutions

EXPORT:CANGZHOU SIJIN INTERNATIONAL TRADING CO.,LTD

Technical &Sales Team By MIKE PIPING SOLUTION

SIJIN
思进国际

CANGZHOU SIJIN INTERNATIONAL TRADING CO.,LTD
沧州思进国际贸易有限公司

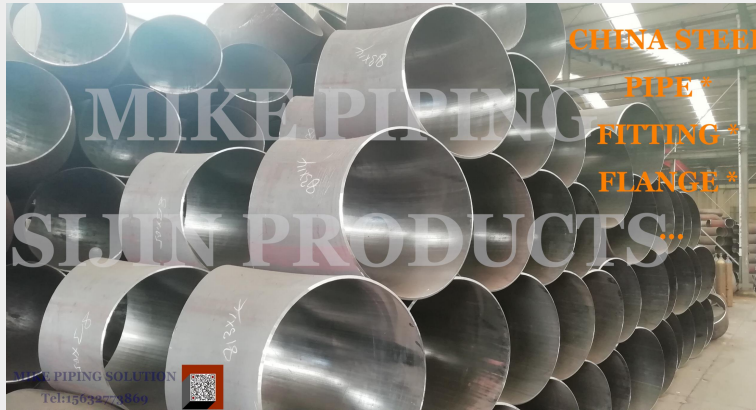



CANGZHOU SIJIN INTERNATIONAL TRADING CO.,LTD
沧州思进国际贸易有限公司

WHY CHOOSE US

Our company sales ANSI ,ASME ,DIN ,JIS ,GOST,GB and other standards of steel pipe, flange, pipe fittings.We have a strong stock capacity, 3,000 tons per day, to ensure that each order is packaged and shipped on the same day.

We use good quality, preferential price, comprehensive product service. Provide pipeline equipment for domestic pipeline projects in China and other countries in the world.

WHO WE ARE

We are Cangzhou Sijin International Trading Co.,Ltd .Since 2018 be called SIJIN PIPING.

We are located in famous Cangzhou , professional Pipe, Fitting, Flange piping Zone

We are the Large diameter elbow stockist for seamless and welded,Size: 8inch to 48inch .

We are manufacturer & stockist butt weld pipe fitting and steel flange .

Carbon Steel/Alloy Steel/ Stainless Steel

WHAT WE DO

Supply piping system products ,trying to be a good piping solution provider. Help customers solve their needs for Material.

Butt Weld Pipe Fittings Products:

Size : 1/8” NB TO 72” NB. (Seamless & 100% X-Ray Welded)

Elbow Long, Short Radius, 45, 90 & 180 Degrees

Tee& cross Equal & Reducing

Reducer CON&ECC

End Cap



CANGZHOU SIJIN INTERNATIONAL TRADING CO.,LTD

沧州思进国际贸易有限公司

Flanges Products:

Weld neck Flanges (WNRF), Slip-on Flanges (SORF), Blind Flanges (BLRF), Lap Joint Flanges (SOLJ), Socket-weld Flanges (SWRF), Screwed (Threaded) Flanges, Long weld neck Flanges (LWNRF), Spectacle Blind Flanges, Spacer & Blind Flanges, Ring Type Joint Flanges (RTJ)

Size: 1/2" (15 NB) to 48" (1200NB)

Standards: ANSI B16.5, ANSI B16.47 Series A & B, MSS SP44

Pressure Ratings: Class 150 to Class 2500 | PN6 to PN64 .

Coating/Surface Treatment: Anti-rust Paint, Oil Black Paint, Yellow Transparent, Zinc Plated, Cold and Hot Dip Galvanized

Value Added Services: CNC Machining, Customised Flanges

Piping Products

Seamless cold drawn precision tubes according to EN-10305-1 (DIN2391)

Pipe Clamp DIN3567A / DIN 3015

Alloy Pipe: A335 P11, P12, P22, P5, P9, A213T11, T12, T22, T5, T9, 15CrMoG, 12Cr1MoVG, 34CrMo4

API 5L Pipeline: GRB, X42-X80, L245-L555

API 5CT Casing Tube: J55, K55, L80 etc

Low temperature steel pipe: A333Gr. 6, 16Mn, Q345B

Carbon steel pipe: A106Gr. B, A53G. rB, 20#, 20G, Q235B

Alloy Pipe fitting & Flange: A234 WPB WP11, WP12, WP22, WP5, WP9, WP91, WP92

Stainless steel pipe fitting: 304, 304L, 316, 316L, 316Ti, 321, 904L etc

Low temperature pipe fitting: A420 WPL6, 16Mn, Q345B

Standard Pipe Fitting & Flange: GB13401, GB12459、ASME/ANSI B16. 9, B16. 5, B16. 11、GOST 12821, 12820、JIS、BS、MS etc

Standard Steel Pipe: GB/t8162, GB/T8163, DIN17175, ASTM series, API 5L, API 5CT etc



FITTINGS

- 90° ELBOWS — **Long Radius** [Schedule: STD, XS, 40, 80, 160, XXS]
- 90° ELBOWS — **Short Radius** [Schedule: STD, XS, 40, 80, 160, XXS]
- 90° REDUCING ELBOWS — [Schedule: STD, XS, 40, 80]
- 90° ELBOWS — **3D** [Schedule: STD, XS, 40, 80]
- 45° ELBOWS — **Long Radius** [Schedule: STD, XS, 40, 80, 160, XXS]
- 45° ELBOWS — **3D** [Schedule: STD, XS, 40, 80]
- 180° RETURN BENDS — **Long Radius** [Schedule: STD, XS, 40, 80, 160, XXS]
- 180° RETURN BENDS — **Short Radius** [Schedule: STD, XS, 40, 80, 160, XXS]
- STRAIGHT TEES — [Schedule: STD, XS, 40, 80, 160, XXS]
- REDUCING TEES — [Schedule: STD, XS, 40, 80, 160, XXS]
- CONCENTRIC AND ECCENTRIC REDUCERS — [Schedule: STD, XS, 40, 80, 160, XXS]
- CAPS — [Schedule: STD, XS, 40, 80, 160, XXS]
- LAP JOINT STUB ENDS — [Schedule: STD, XS, 40, 80, 160, XXS]

FLANGES

- CLASS 125
- CLASS 150
- CLASS 300
- Class 600
- Class 900
- Class 1500
- Class 2500

FITTINGS

1/2" through 60"

- Schedule Standard (STD)
- Schedule Extra Strong (XS)
- Schedule 40
- Schedule 80
- Schedule 160
- Schedule Double Extra-Strong (XXS)

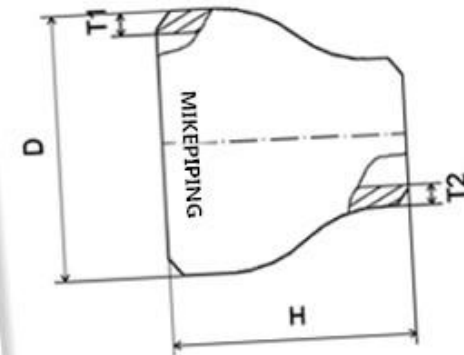
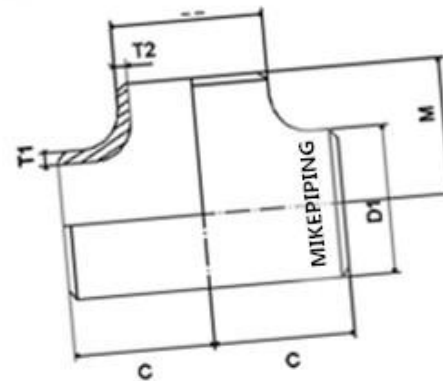
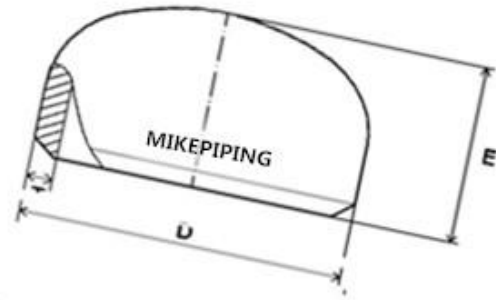
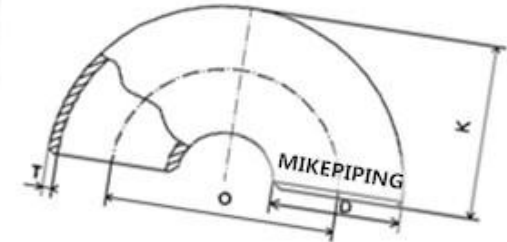
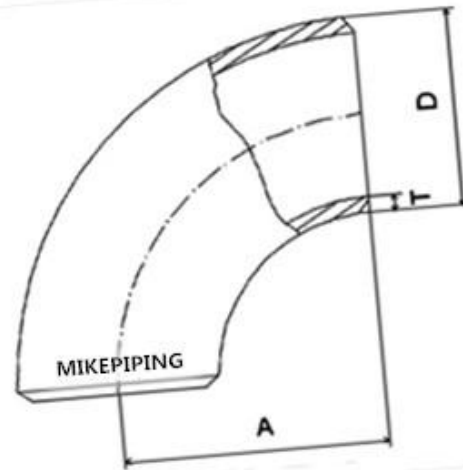
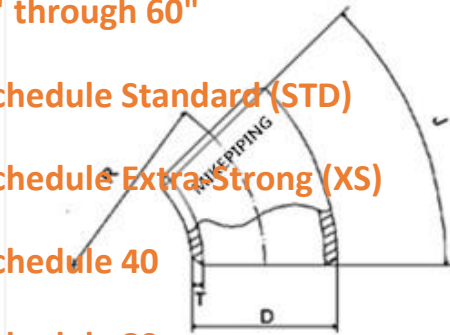

FLANGES

1/2" through 60"

- Class 125
- Class 150
- Class 300
- Class 600
- Class 900
- Class 1500
- Class 2500



Flange Specs

- - AWWA C207 B Ring
- - AWWA C207 D Ring
- - AWWA C207 E Ring
- - AWWA C207 F Ring
- - AWWA C207 Hub Flanges
- - AWWA C228 SS Ring SA, SB, SD, SE
- - AWWA C228 SS Ring SF
- - AWWA C228 SS Blinds
- - ANSI B16.5 150
- - ANSI B16.5 300
- - ANSI B16.5 400
- - ANSI B16.5 600
- - ANSI B16.5 900
- - ANSI B16.5 1500
- - ANSI B16.5 2500
- - ANSI B16.1 125 Slip On
- - ANSI B16.1 125 Weldneck
- - ANSI B16.1 250
- - ASME B16.47 Series A Class 150
- - ANSI 150 Lap Joint per SO Lth
- - ASME B16.47 Series A Class 300
- - ASME B16.47 Series A Class 400
- - ASME B16.47 Series A Class 600
- - ASME B16.47 Series A Class 900

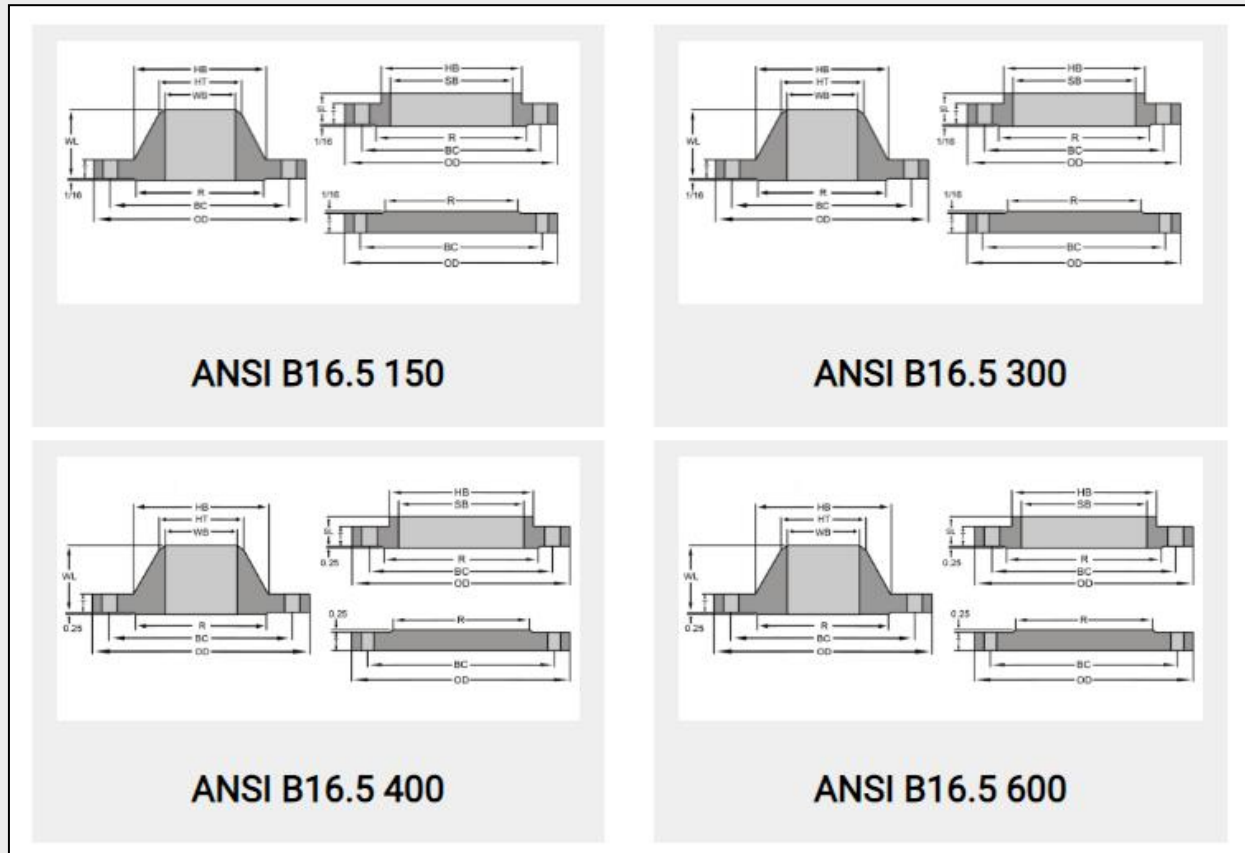

- - ASME B16.47 Series B Class 75
- - ASME B16.47 Series B Class 150
- - ASME B16.47 Series B Class 300
- - ASME B16.47 Series B Class 400
- - ASME B16.47 Series B Class 600
- - ASME B16.47 Series B Class 900
- - DI Backup Flanges
- - Stainless Backup Flanges
- - Class 125 Lightweight
- - Class 75 Industry Std Slip On
- - Class 75 Industry Std Weldneck
- - Class 175 Industry Std
- - Class 350 Industry Std

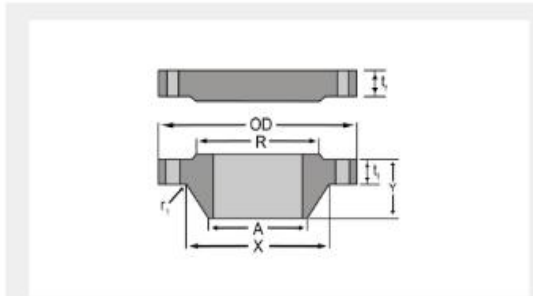

**ASME B16.47 Series A Class
150**

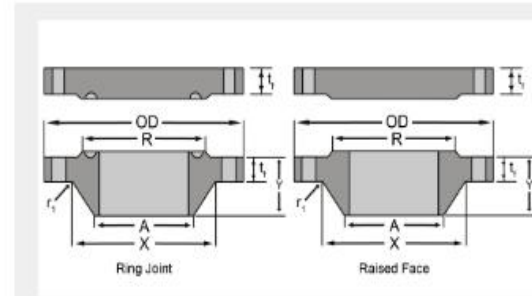

**ASME B16.47 Series A Class
300**

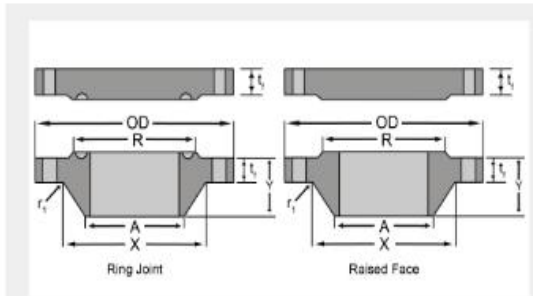

**ASME B16.47 Series A Class
400**

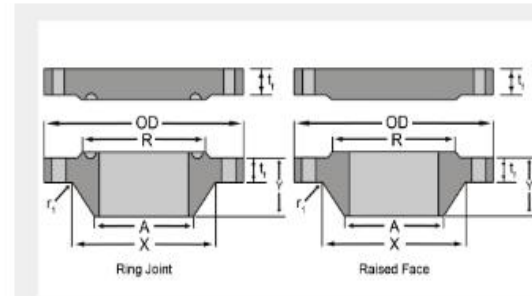

**ASME B16.47 Series A Class
600**

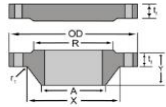

ASME B16.47 Series B Class 150

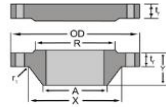

ASME B16.47 Series B Class 300

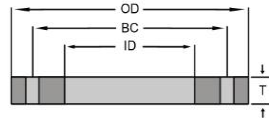

AWWA C207 B Ring

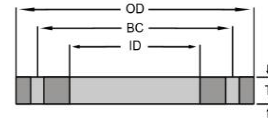

AWWA C207 D Ring

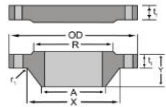

ASME B16.47 Series B Class 400

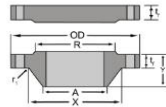

ASME B16.47 Series B Class 600

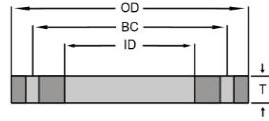

AWWA C207 E Ring

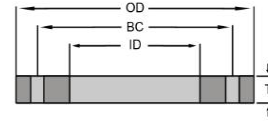

AWWA C207 F Ring

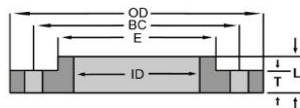

AWWA C207 Hub Flanges

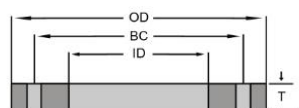

AWWA C228 SS Ring SA, SB, SD, SE

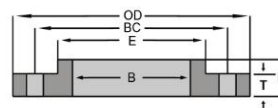

Class 125 Lightweight

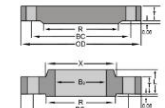

Class 75 Industry Std Slip On

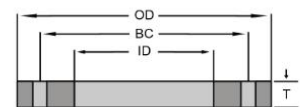

AWWA C228 SS Ring SF

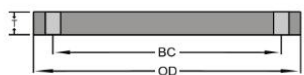

AWWA C228 SS Blinds

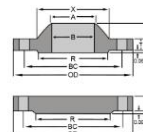

Class 75 Industry Std Weldneck

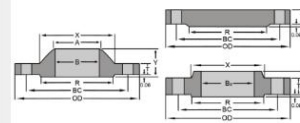

Class 175 Industry Std

Customized according to drawings

Butt Weld Fittings



FITTING TYPES INCLUDE:

- 90 LR/SR Elbows
- 90 Reducing Elbows
- 45 Elbow
- Straight and Reducing Tees
- Concentric and Eccentric Reducers
- 180 LR/SR Return Bends
- Caps
- Crosses

Sizes: 1/2" to 24"

Wall Thickness: STD, XH, SCH.20, 40, 80, 160, and XXH

Materials: Carbon Steel, ASTM A234-WPB

Dimensions: ANSI B16.9

PRODUCTING



FLANGES

CARBON STEEL FLANGES

- Lightweight Steel Ring Flanges
- AWWA Class "D" Ring Flanges
- 150 #, 300 # Slip-On Raised Face Flanges
- Blind Flanges
- 150 #, Threaded
- 150 #, Welding Neck
- Custom Flanges to Your Specification

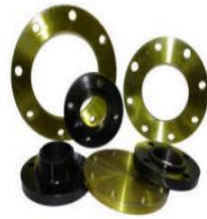

STAINLESS STEEL FLANGES

- Lightweight
- AWWA Class "D"
- Custom Stainless Steel Flanges to Your Specification





CANGZHOU SIJIN INTERNATIONAL TRADING CO.,LTD

沧州思进国际贸易有限公司

MADE IN CHINA

Make the good product

Welcome to visit us

Thank You

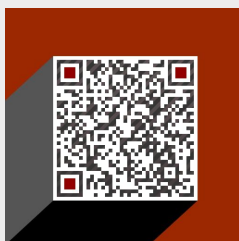

EXPORT:CANGZHOU SIJIN INTERNATIONAL TRADING CO.,LTD

www.sijinpiping.com

ADD :B4-2-1102, Jinxiu Tiandi, Yunhe District, Cangzhou City, Hebei Province , China.

E-MAIL:sjinsteel@hotmail.com TEL:15632773869 Contact :Mr.Mike Hu